

KENNELS

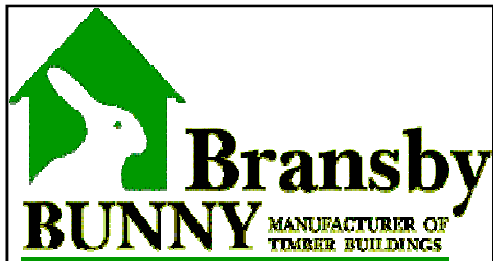

ALL OUR KENNELS ARE PRESSURE TREATED. THIS PROTECTS THE TIMBER AGAINST ROT, THEREFORE EXTENDING THE TIMBER LIFE.

ASSEMBLY AND DELIVERY CHARGES MAY APPLY

**BRANSBY BUNNY, TOP COTTAGE, BLYBOROUGH GRANGE, GAINS, LINCS, DN21 4UD
TEL: (01673) 818682 FAX: (01673) 818530**

Web: www.bransby-bunny.co.uk Email: info@bransby-bunny.co.uk

E & O.E.

Page 1

COMMITTED TO CUSTOMER SATISFACTION

BRANSBY BUNNY

Established in 1977, Bransby Bunny Timber Buildings is a family run business and has earned an enviable reputation in manufacturing timber buildings of the highest quality and provide an unequalled customer service. We supply a wide range of buildings direct to the customer. However, if you are unable to find the exact building you are looking for then do not hesitate to contact the office for information. We build to customers own personal requirements and design specification.

Whatever the timber, fittings or materials used in the construction of our buildings, they are carefully selected, with each project constantly monitored for quality at every stage through the factory. All our staff have a responsibility to work to the highest standards so that on final installation, any Bransby Bunny building will automatically compliment it's surroundings.

Our company is committed to achieving customer satisfaction for you.

All timber used in the manufacture of your building is tanalised (pressure treated), i.e. treated against rot for longevity. Although your unit is manufactured from tanalised timber, we highly recommend that a treatment of your building (not forgetting the roof timber trims) be given within one month from delivery and thereafter, annually. As timber is a natural product, the drying effects of the sun and absorption from the rain affect it. By sealing your building this will give maximum protection from the sun and repel the water from the rain. If you like the natural colour of your unit, two coats of a clear Ronseal Decking Seal should be applied (available from any DIY Superstore).

Specification

- All measurements are shown as imperial.
- Top-quality slow grown Deal timber.
- 38mm x 50mm (1.5" x 2") round edged, planed timber.
- Quality glass fibre based roofing felt as standard.
- Galvanised (or similar) ironmongery to protect against rusting.
- Personal, friendly service, keeps you in touch with your order prior to delivery.
- Pay by cash, cheque, credit card, or we can arrange a favourable Hire Purchase Agreement
- Orders accepted by Post, Phone, Fax, Online via our secure Website, or call at our Large Show site.
- Most deliveries on our own vehicles.
- Special orders are our speciality.
- A nominal fee of £50.00 is charged to customise buildings.

Base Suggestions

Your base structure is VERY important. It must be firm, level and of sufficient size to accommodate the size of the building that you order. As a general guide, better too big than too small. The dimensions in the brochure are for the outside body of the building, not allowing for any roof overhang which is approximately 2.5" all round. Please remember, if you have ordered the assembly service your base must be ready and comply with the above suggestions.

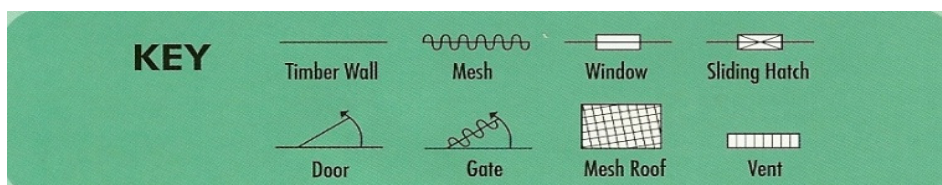

BRANSBY BUNNY—ESTABLISHED 1977

The Stow



SIZE	PRICE	LINE/ INSULATE
3' x 4' HOUSE WITH 6' x 4' COVERED RUN	£562.00	£164.00
4' x 4' HOUSE WITH 6' x 4' COVERED RUN	£610.00	£201.00
5' x 4' HOUSE WITH 6' x 4' COVERED RUN	£662.00	£228.00
6' x 4' HOUSE WITH 6' x 4' COVERED RUN	£716.00	£260.00

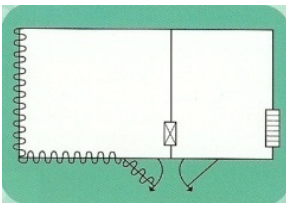

This kennel is based on our popular Pelham kennel but with an added covered side run. This kennel has the features of the Tennyson kennel but is a more compact unit so as not to dominate its surroundings. A stable door is supplied as standard on the kennel with a connecting sliding hatch to the run. The run can be manufactured to fit either side of the kennel.

The Stow Special



If more run is required, the Stow Special offers a porch area to the side of the kennel, with a timber floor. Plus an additional covered timber run to the front of the kennel.

Kennel Size	Back Porch with Timber Floor	Covered Timber Run	Price	Line/ Insulate
3' x 4'	4' x 4'	7' x 6'	£933.00	£164.00
4' x 4'	4' x 4'	8' x 6'	£1,049.00	£201.00
5' x 4'	4' x 4'	9' x 6'	£1,171.00	£228.00
6' x 4'	4' x 4'	10' x 6'	£1,293.00	£260.00
3' x 4'	5' x 4'	8' x 6'	£1,039.00	£164.00
4' x 4'	5' x 4'	9' x 6'	£1,161.00	£201.00
5' x 4'	5' x 4'	10' x 6'	£1,277.00	£228.00
6' x 4'	5' x 4'	11' x 6'	£1,399.00	£260.00
3' x 4'	6' x 4'	9' x 6'	£1,145.00	£164.00
4' x 4'	6' x 4'	10' x 6'	£1,177.00	£201.00
5' x 4'	6' x 4'	11' x 6'	£1,383.00	£228.00
6' x 4'	6' x 4'	12' x 6'	£1,505.00	£260.00

BRANSBY BUNNY—ESTABLISHED 1977

The Tennyson

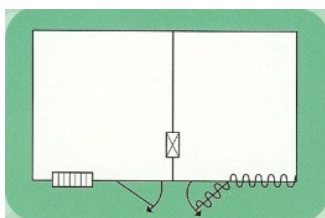

SIZE	PRICE	LINE/ INSULATE
3' x 4' HOUSE WITH 6' x 4' COVERED RUN	£705.00	£207.00
4' x 4' HOUSE WITH 6' x 4' COVERED RUN	£753.00	£244.00
5' x 4' HOUSE WITH 6' x 4' COVERED RUN	£827.00	£286.00
6' x 4' HOUSE WITH 6' x 4' COVERED RUN	£890.00	£323.00

The Tennyson kennel has an integral side run. This layout offers a high degree of protection from the weather for your dogs, whilst at the same time providing plenty of room for freedom of movement. The run can be constructed on either side of the kennel to suit the customers preference. A removable floor can be fitted in the run as an option if required.

The Tennyson Special



If more run is required, the Tennyson Special has the option of a further run to the front. This additional run can be either open topped or covered, in steel or timber.



SIZE	ADDED COVERED STEEL RUN	PRICE
3' x 4' WITH 6' x 4' RUN	9' x 6'	£1,664.00
4' x 4' WITH 6' x 4' RUN	10' x 6'	£1,823.00
5' x 4' WITH 6' x 4' RUN	11' x 6'	£1,945.00
6' x 4' WITH 6' x 4' RUN	12' x 6'	£2,088.00

ADDED OPEN TOP STEEL RUN	PRICE
9' x 6'	£1,261.00
10' x 6'	£1,330.00
11' x 6'	£1,431.00
12' x 6'	£1,510.00

SIZE	ADDED COVERED TIMBER RUN	PRICE
3' x 4' WITH 6' x 4' RUN	9' x 6'	£1,442.00
4' x 4' WITH 6' x 4' RUN	10' x 6'	£1,553.00
5' x 4' WITH 6' x 4' RUN	11' x 6'	£1,664.00
6' x 4' WITH 6' x 4' RUN	12' x 6'	£1,776.00

ADDED OPEN TOP TIMBER RUN	PRICE
9' x 6'	£1,049.00
10' x 6'	£1,113.00
11' x 6'	£1,203.00
12' x 6'	£1,277.00

COMMITTED TO CUSTOMER SATISFACTION

The Pelham

A low height kennel, the Pelham will sit unobtrusively wherever you need to site it and it is also available with a covered or open run. It can also be supplied in multiple units.

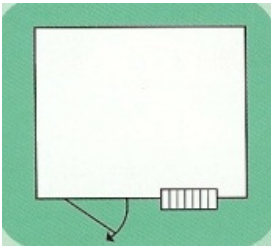

Block of two 4' x 4' kennels with 4' x 6' covered runs. Overall size – 8' x 10'



6' x 4' kennel with 6' x 6' covered steel run. Overall size – 6' x 10'

STYLE	PRICE 1 ST UNIT	ADD-ON UNITS	LINE/ INSULATE
4' x 3' KENNEL	£270.00	£228.00	£164.00
4' x 4' KENNEL	£318.00	£270.00	£201.00
5' x 4' KENNEL	£366.00	£313.00	£228.00
6' x 4' KENNEL	£419.00	£355.00	£260.00
4' x 3' WITH 4' x 6' OPEN RUN	£541.00	£413.00	£164.00
4' x 4' WITH 4' x 6' OPEN RUN	£594.00	£456.00	£201.00
5' x 4' WITH 5' x 6' OPEN RUN	£657.00	£514.00	£228.00
6' x 4' WITH 6' x 6' OPEN RUN	£721.00	£567.00	£260.00
4' x 3' WITH 4' x 6' COVERED RUN	£562.00	£482.00	£164.00
4' x 4' WITH 4' x 6' COVERED RUN	£610.00	£519.00	£201.00
5' x 4' WITH 5' x 6' COVERED RUN	£731.00	£625.00	£228.00
6' x 4' WITH 6' x 6' COVERED RUN	£859.00	£726.00	£260.00

6' Deep Covered Steel Run

KENNEL SIZE	RUN SIZE	1 ST UNIT	ADD-ON UNIT
4' x 3'	4' x 6'	£737.00	£625.00
4' x 4'	4' x 6'	£790.00	£673.00
5' x 4'	5' x 6'	£928.00	£790.00
6' x 4'	6' x 6'	£1,065.00	£912.00

8' Deep Covered Steel Run

KENNEL SIZE	RUN SIZE	1 ST UNIT	ADD-ON UNIT
4' x 3'	4' x 8'	£890.00	£753.00
4' x 4'	4' x 8'	£943.00	£800.00
5' x 4'	5' x 8'	£1,108.00	£943.00
6' x 4'	6' x 8'	£1,283.00	£1,086.00

10' Deep Covered Steel Run

KENNEL SIZE	RUN SIZE	1 ST UNIT	ADD-ON UNIT
4' x 3'	4' x 10'	£1,044.00	£885.00
4' x 4'	4' x 10'	£1,097.00	£933.00
5' x 4'	5' x 10'	£1,293.00	£1,097.00
6' x 4'	6' x 10'	£1,489.00	£1,267.00

BRANSBY BUNNY—ESTABLISHED 1977

The Carholme

Ideal for all types of dog, it can be used for multiple kennel blocks as illustrated. The Carholme is a tall kennel for the more serious dog-keeper, allowing easy access for cleaning out and the care of your dogs.

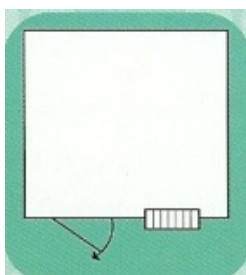

SIZE	PRICE 1 ST UNIT	ADD-ON UNITS	LINE/ INSULATE
4' x 3' KENNEL	£339.00	£286.00	£207.00
4' x 4' KENNEL	£403.00	£344.00	£244.00
5' x 4' KENNEL	£461.00	£387.00	£286.00
6' x 4' KENNEL	£519.00	£445.00	£323.00
4' x 3' WITH 4' x 6' OPEN RUN	£610.00	£466.00	£207.00
4' x 4' WITH 4' x 6' OPEN RUN	£673.00	£525.00	£244.00
5' x 4' WITH 5' x 6' OPEN RUN	£747.00	£594.00	£286.00
6' x 4' WITH 6' x 6' OPEN RUN	£827.00	£657.00	£323.00
4' x 3' WITH 4' x 6' COVERED RUN	£705.00	£599.00	£207.00
4' x 4' WITH 4' x 6' COVERED RUN	£768.00	£652.00	£244.00
5' x 4' WITH 5' x 6' COVERED RUN	£922.00	£784.00	£286.00
6' x 4' WITH 6' x 6' COVERED RUN	£1,076.00	£912.00	£323.00



6' Deep Covered Steel Run

KENNEL SIZE	RUN SIZE	1 ST UNIT	ADD-ON UNIT
4' x 3'	4' x 6'	£933.00	£795.00
4' x 4'	4' x 6'	£1,002.00	£853.00
5' x 4'	5' x 6'	£1,171.00	£996.00
6' x 4'	6' x 6'	£1,352.00	£1,150.00

Block of three 4' x 4' kennels with 4' x 6' covered runs

8' Deep Covered Steel Run

4' x 3'	4' x 8'	£1,129.00	£959.00
4' x 4'	4' x 8'	£1,192.00	£1,018.00
5' x 4'	5' x 8'	£1,404.00	£1,187.00
6' x 4'	6' x 8'	£1,616.00	£1,373.00



10' Deep Covered Steel Run

4' x 3'	4' x 10'	£1,325.00	£1,124.00
4' x 4'	4' x 10'	£1,389.00	£1,182.00
5' x 4'	5' x 10'	£1,627.00	£1,389.00
6' x 4'	6' x 10'	£1,887.00	£1,606.00

Block of two 4' x 4' kennels with 4' x 6' open steel runs.

COMMITTED TO CUSTOMER SATISFACTION

The Canwick



Illustrates 4' x 4' kennel with 6' x 4' covered run. Overall size – 4' x 10'

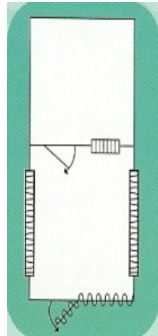

SIZE	PRICE 1 ST UNIT	ADD-ON UNITS	LINE/ INSULATE
4' x 3' KENNEL WITH 4' x 6' COVERED RUN	£832.00	£726.00	£207.00
4' x 4' KENNEL WITH 4' x 6' COVERED RUN	£896.00	£784.00	£244.00
5' x 4' KENNEL WITH 5' x 6' COVERED RUN	£1,044.00	£906.00	£286.00
6' x 4' KENNEL WITH 6' x 6' COVERED RUN	£1,198.00	£1,039.00	£323.00

Covered kennel and run option to complement the Carholme Kennel. The run front is fully meshed and the sides are solid with timber shutters closing over the mesh panel. The kennel is fitted with a stable door and vent.

The Ruskin



The picture above illustrates a 4' x 4' kennel with 6' x 4' open run.

Overall size – 4' x 10'

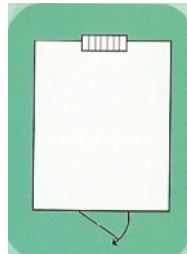

SIZE	PRICE	LINE/ INSULATE
4' x 4' KENNEL	£466.00	£217.00
5' x 4' KENNEL	£519.00	£244.00
6' x 4' KENNEL	£556.00	£313.00
4' x 4' WITH 4' x 6' OPEN RUN	£731.00	£217.00
5' x 4' WITH 5' x 6' OPEN RUN	£811.00	£244.00
6' x 4' WITH 6' x 6' OPEN RUN	£859.00	£313.00

An attractive single unit kennel, suitable for most dogs. This kennel is also available with a covered or open run.

The Ridgeway



Internal division with pop hole. Hinged roof to allow for easy cleaning

SIZE	PRICE	LINE/ INSULATE
3' x 2'	£244.00	£148.00
3' x 4'	£307.00	£175.00
5' x 4'	£387.00	£201.00

The Imp



Illustrates 4' x 2'6" kennel and 3' x 2' kennel

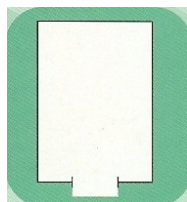

SIZE	PRICE	LINE/ INSULATE
4' x 2'6" KENNEL	£212.00	£122.00
3' x 2'	£164.00	£95.00

The Imp provides a sturdy shelter for your dog with an open entrance way. The back panel of the kennel is removable to facilitate easy cleaning. The Imp is suitable for placing in your garden, run compound or, if required, a run can be fitted directly to it.

BRANSBY BUNNY – ESTABLISHED IN 1977

The Cabin



This picture illustrates a Cabin in a secure enclosure.

SIZE	PRICE	LINE/ INSULATE
4' x 2'6" KENNEL	£212.00	£122.00
3' x 2' KENNEL	£164.00	£95.00

The Cabin kennel is similar to the Imp but has a roof that lifts up, as opposed to a removable back panel, for ease of cleaning and installing beds.

The Grange



SIZE	PRICE
6' x 4' WITH ALL MESH FRONT	£276.00
6' x 4' WITH HALF BOARDED FRONT	£249.00

The Grange is a run and a house combined in one. Safety for your dog at great value.

STANDARD PANELS

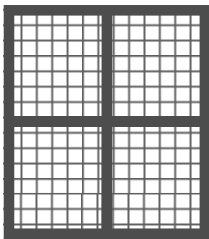

STANDARD PENFRONTS

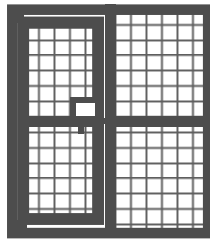

RUN SIZE	PRICE 1 ST UNIT	ADD-ON UNIT
6' x 4'	£312.00	£217.00
6' x 5'	£322.00	£227.00
6' x 6'	£338.00	£243.00

4' High Steel Runs



6' High Steel Runs

6' x 4'	£444.00	£296.00
7' x 4'	£528.00	£338.00
8' x 4'	£560.00	£354.00
9' x 4'	£592.00	£370.00
6' x 5'	£466.00	£318.00
7' x 5'	£550.00	£360.00
8' x 5'	£582.00	£376.00
9' x 5'	£614.00	£392.00
6' x 6'	£487.00	£339.00
7' x 6'	£571.00	£381.00
8' x 6'	£603.00	£397.00
9' x 6'	£635.00	£413.00

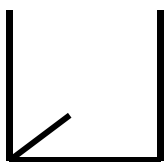

FIRST UNIT

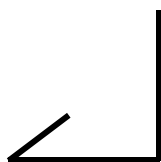

ADD-ON UNIT

Galvanised steel runs are available in many popular sizes. However, if you are wanting to build your own run then please look at our separate panel price list.

COMMITTED TO CUSTOMER SATISFACTION

Dog Beds

SIZE	PRICE
TO FIT 4' x 4' KENNEL	£42.00
TO FIT 4' x 5' KENNEL	£53.00
TO FIT 5' x 5' KENNEL	£58.00
TO FIT 6' x 4' KENNEL	£69.00

Pop Holes

Standard Size is
17" high x 11" wide

SIZE	PRICE
SIZE 2 - 24" x 16"	£32.00
SIZE 3 - 30" x 18"	£37.00
SIZE 4 - 36" x 18"	£42.00

Whelping boxes

Plastic crush rails are
£11.00 per set.



SIZE	PRICE
2' x 2'	£106.00
3' x 2'	£132.00
3' x 3'	£164.00
4' x 3'	£191.00
4' x 4'	£223.00

Anti-Chew Strips - 48"

£11.00 each



Handle and Hook Sliding Hatch Kit -



SIZE	PRICE
N/A	£111.00

Sleeping Benches -



SIZE	PRICE
3' x 2'	£74.00
3' x 3'	£85.00
4' x 2'	£85.00
4' x 3'	£106.00

Dog Bowl and Holder -

£37.00 per set



HOW TO FIND US:

From Gainsborough (13.5 miles) – Head east out of the town up the dual-carriageway (Thorndike Way – A631). Continue forward onto Corringham Road until you come into the village of Corringham. Continue straight through the village staying on the A631 for approximately 4.2 miles and come to a roundabout. Take the 2nd exit continuing on the A631. Continue for approximately 1.9 miles and come to a 2nd roundabout with a Total Petrol Station. Once at this roundabout take the 1st exit – sign-posted A15 Scunthorpe. (Beware Speed Cameras). On the A15 continue for approximately 3 miles, we are on the LEFT hand side of the A15 roadside. Look for a sign-post for ‘Blyborough’ – take this turning and then immediately turn right into our car park.

From Newark (32 miles) – Head north-east out of Newark on the A46 for 17 miles towards Lincoln. Stay on the A46 (Lincoln Ring-Road) going through several roundabouts. At ‘Riseholme Roundabout, take the first exit onto the A15 heading towards Scunthorpe. Once on the A15 travel for 10 miles to ‘Caenby Corner Roundabout’ (Total Petrol Station on roundabout). Take second exit continuing on the A15. (Speed Cameras) Travel for approximately 3 miles; we are on the LEFT hand side on the A15 roadside. Look for a sign-post for ‘Blyborough’ – take this turning and then immediately turn right into our car park.

From Lincoln (15 miles) – Head north out of Lincoln. At ‘Riseholme Roundabout, take the second exit onto the A15 heading towards Scunthorpe. Once on the A15 travel for 10 miles to ‘Caenby Corner Roundabout’ (Total Petrol Station on roundabout). Take second exit continuing on the A15. (Speed Cameras) Travel for approximately 3 miles; we are on the LEFT hand side on the A15 roadside. Look for a sign-post for ‘Blyborough’ – take this turning and then immediately turn right into our car park.

From Scunthorpe (12.5 miles) – Head south-east out of the town on the A18. At the roundabout take the last exit onto the A15. Almost immediately you will come to a second roundabout, go through this following sign posts for the ‘A15 Lincoln’. Continue on the A15 for approximately 8 miles until you come to a sign-post for ‘Blyborough’ (just before a speed camera) – turn right into this junction and then immediately right into our car park. We are on the RIGHT, on the A15 roadside.

From M180 – If you are coming to us on the M180 leave the motorway at Junction 4. At the roundabout follow sign posts for A15 Lincoln. Continue on the A15 for approximately 8 miles until you come to a sign-post for ‘Blyborough’ (just before a speed camera) – turn right into this junction and then immediately right into our car park. We are on the RIGHT, on the A15 roadside.

Our policy is one of constant improvement and all specifications may be changed without prior notice.

All sizes on the brochures are nominal and are subject to production variation.

GENERAL CONDITIONS OF SALE

1. GENERAL

- a) The Company means BRANSBY BUNNY
- b) The Customer means the person(s) or business ordering or buying Goods from the Company.
- c) The Goods mean the goods or services that are the subject of the relevant order or contract for sale
- d) The Conditions of Sale apply to all products manufactured, supplied and assembled by the Company unless varied by negotiation and confirmed by us in writing.
- e) All illustrations, data and other information contained in our brochure, catalogues, advertisements, price lists, technical data sheets or other documents, are approximate only and shall not form part of the contract.
- f) These conditions dated January 2004 supersede any earlier
- g) Please read carefully as all conditions will be strictly adhered to. Quotations accepted and orders placed by Customers are on the understanding that these conditions have been read and accepted. Where there are additional conditions that apply to a specific supply/assembly of Goods, then these will be included in our quotation.

2. PRICE AND TERMS OF PAYMENT

- a) All quoted prices are inclusive of the vat rate applicable at the date of quote.
- b) A payment of 25% is required on all orders before construction can commence. Cheques/ postal orders to be made payable to BRANSBY BUNNY. The balance of money owing to be paid 10 days before delivery.
- c) If for any reason the Customer is unable to accept delivery when due, we will if facilities permit, store the Goods at their risk until delivery and reserve the right to make additional charges for such storage and any extra handling and transportation.
- d) Should an order be cancelled once production has commenced, the Customer will be charged with the proportion of work completed and the 25% payment in advance will be used to offset the amount due.
- e) No payment by cash will be accepted with regard to any one transaction or as a series of linked transactions for amounts in excess of the limit set by Money Laundering Regulations (15,000 Euros). Customers wishing to pay such amounts must do so using no-cash methods.

3. RETENTION OF TITLE

After delivery, ownership of the Goods shall not pass from the Company until:-

- a) The price has been paid in full including vat.
 - b) No other sums whatsoever are due from the Customer to the Company.
- Until such time as ownership of the Goods has passed from the Company to the Customer, the Customer will, if requested, deliver up to the Company such of the Goods as have not ceased to be in existence or resold. If the Customer fails to do so, the Company or their duly authorised agents may enter any premises where the Goods are situated and repossess the Goods.

4. SIZES

The overall size of our timber buildings are approximately 6" (150mm) larger than shown on the brochure/documentation to allow for the roof overhang. This should be taken into account when laying the base.

5. ORDERS

When ordering and to avoid mistakes, please supply the following details. Name, full address and delivery address if different. Home and business telephone number (mobile numbers can be a help if possessed). Product required. Size, type etc. Door positions with tee hinges marked to indicate opening. Any other special requests relating to the order. The Customer should check the quotation or production schedule issued by the Company to see that the specification meet requirements and return the quotation/order acceptance letter or order confirmation letter.

6. DELIVERY AND ASSEMBLY

- a) Times and dates for the despatch or delivery of the Goods or for the completion of any works are estimates only given in good faith and shall not be binding upon the Company either as a term of contract or otherwise. In no circumstances shall the Company be liable for any loss or damage sustained by the Customer in consequence of a failure to deliver, start or complete within such time or by such date or in consequence of any delay in delivery however caused.
- b) Notwithstanding clause 3 (retention of title) when Goods are delivered by the Company, risk shall pass to the Customer on deliver.
- c) The Company is pleased to offer an assembly service to the Customer. The assembly date is dependant on there being sufficient orders for assembly in a particular area. If you require an earlier date, then there may be an additional cost, which will be notified to you in advance. Alternatively, delivery can be made by carrier for the Customer to assemble themselves. Assembly will only take place subject to the following conditions
 1. The distance from the lorry to the point of delivery must not exceed 30 metres. Distances beyond this will incur extra time to that allowed in the price. The cost for this additional work to be assessed on site and paid directly to the Company's representative. A receipt will be given on payment being made.
 2. The site onto which the buildings are to be assembled must be level, be laid in advance of delivery and be constructed of concrete or concrete slabs. The Company accepts no responsibility should the Customer direct the assembly of a building onto an unlevelled or unprepared base. If the building has to be assembled tightly into a corner or flush to a wall, sufficient space must be available to pass and re-pass. The Company's insurance cover does not permit the carrying of materials through houses or up and down flights of stairs or steeply sloping grassy banks. In the event of there being no suitable side entrance, delivery will take place to the closest off-loading point. Under no circumstances will the Company's employees/representative lift heavy sections over fences, gates, walls or garage rooves. At all time the Company will work according to Health and Safety regulations.

7. SPECIFICATIONS

Specification and illustrations are quoted prior to machining. Every precaution is taken to see that timber is suitable for its use, but because wood is a natural product and reacts to varying weather conditions and locations, the Company can therefore accept no responsibility for contraction or expansion however caused. Buildings are treated with preservative before delivery but it is the Customer's responsibility to maintain the Goods to ensure it remains presentable and waterproof. Owing to factors often outside our control, once a felt-roofed unit has been assembled on site we cannot offer a specific warranty on the felt used. If a claim is made for a faulty felt roof we will offer a free site survey as soon as practicable and deal with the matter on case-by-case basis with the costs allocated by agreement.

8. CLAIMS

No claims will be entertained unless notified within 3 days of delivery/assembly, first by telephone then by letter setting out in detail the nature of the claim or damage.